



# TOTNES HYDROPOWER SCHEME

Totnes Weir hydropower scheme will bring significant hydropower to Totnes, whilst improving conditions for fish passage on the River Dart.



## POWER GENERATION

Twin Archimedes Screw turbines will generate clean renewable electricity for Totnes.

- Max output: 320kW
- Est. annual output: 1,200,000 kWh
- Enough electricity to power 400 average households
- CO2 saved: 500 tonnes annually

The scheme will supply KEVICC's school and ATMOS Totnes with green electricity.

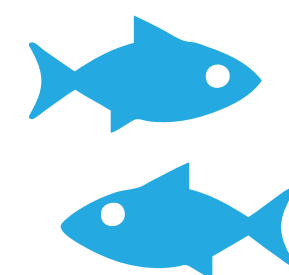

## FISH PASSAGE

A new best practice fish pass will be installed adjacent to the turbines to allow more salmon and sea trout to migrate past the weir and spawn in the Dart catchment.

An automatic fish counter is also being installed to monitor the number and sizes of fish using the pass.

Extensive research has proven that fish can pass through the slowly rotating turbine with no adverse effects.



A recreational public space will be created near the turbine house with information about the scheme.



A new canoe launch platform will be created.



As well as helping to power KEVICC's school there is the potential to create an educational facility at the control building.

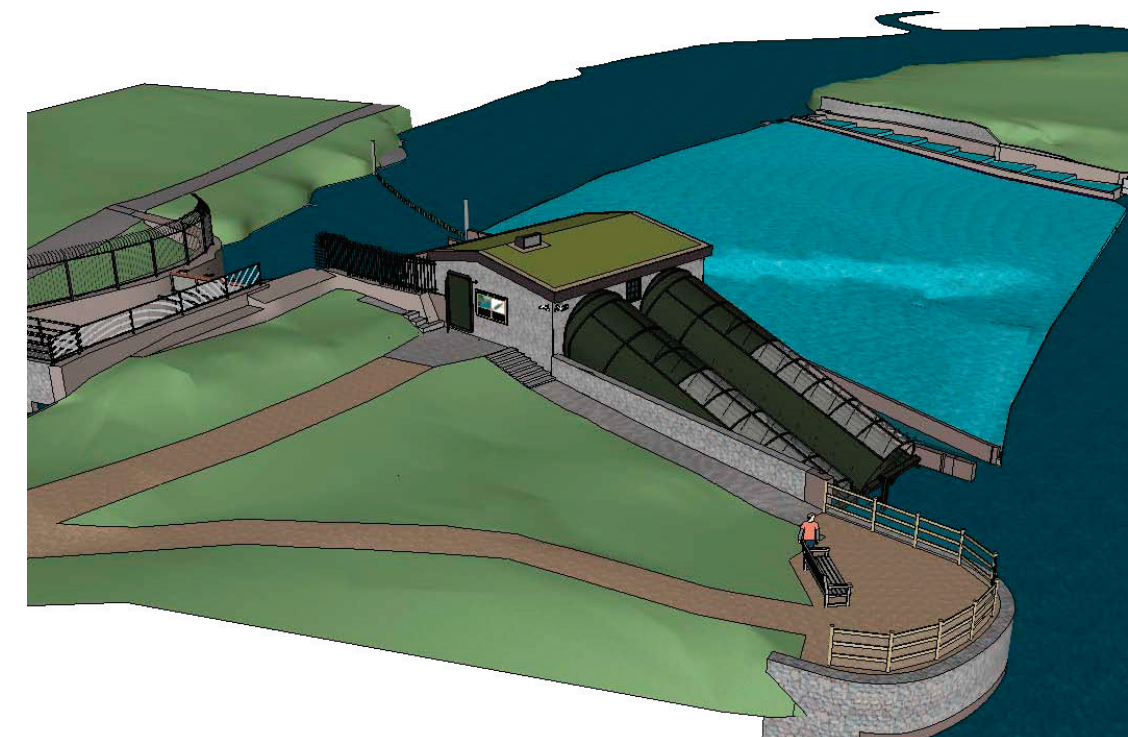
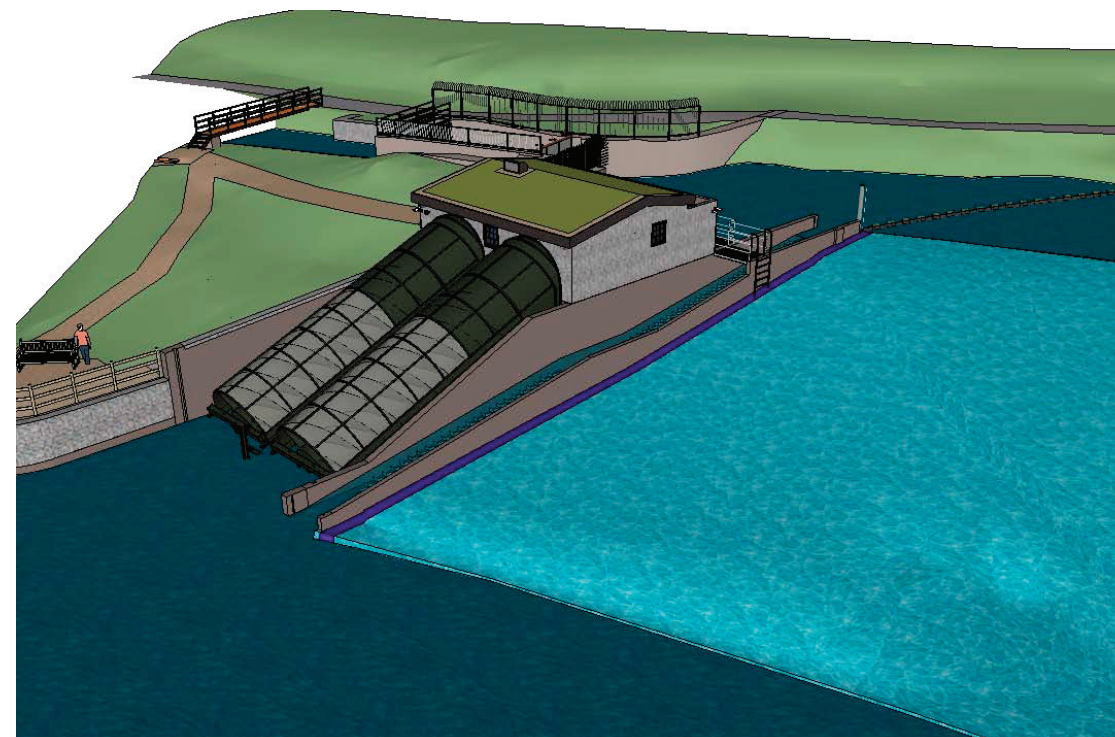
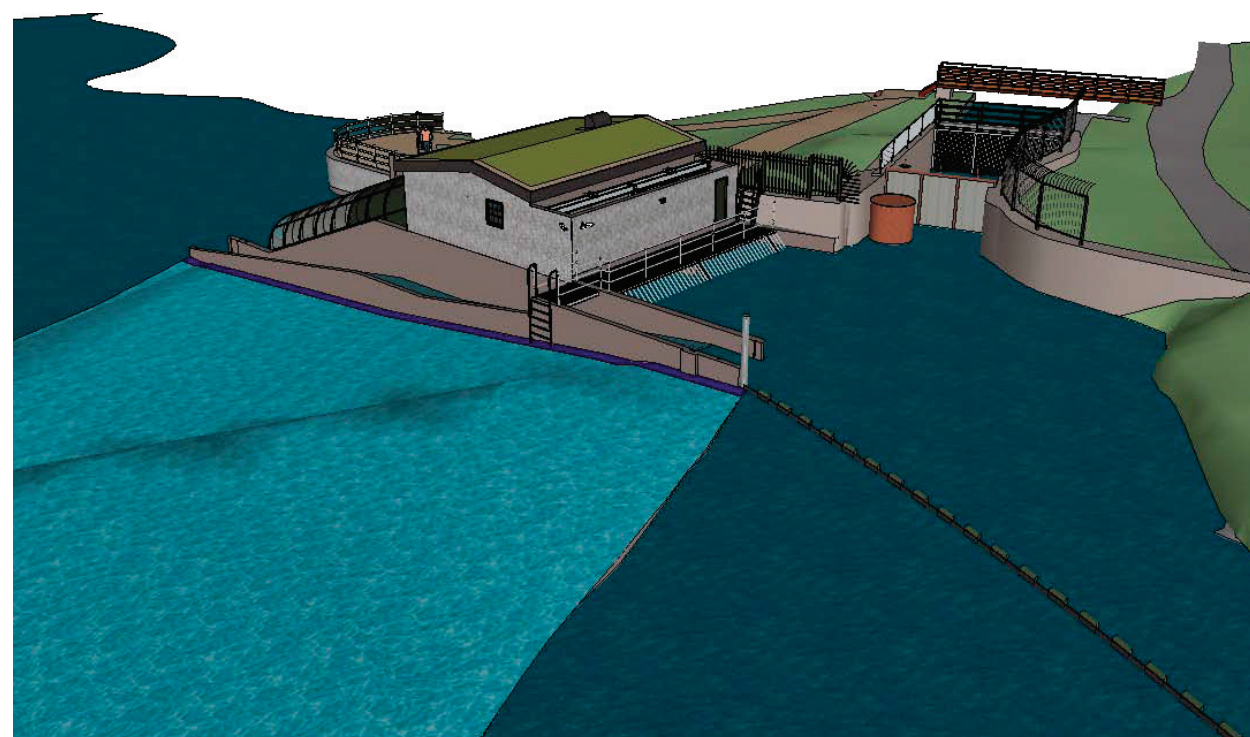

**Footpath closed during construction for health and safety. We apologize for any inconvenience.**

For more information please contact: **John Edmonds on 01803 866680**

Project completion date: **Dec 2015**